

BLESSINGS

I

Mohammadi Educational Trust



Kolkata, INDIA



LAUNCHING A MEGA PROJECT.



Project

**MET
PUBLIC SCHOOL**



**To be established at Basanti Highway, S-24 Pgns , Kolkata Connector.
8.5 kms from Science City, Kolkata.**

PHASE-1
LAND PURCHASE DRIVE



MOTIVATION

WHY MET PUBLIC SCHOOL MUST BE BUILT ?

At MET PUBLIC SCHOOL students would be fed with Knowledge, shaped with Character, Morality, Ideology, Principles & Life Skills essential for being an ideal Citizen of the Nation. Irrespective of Caste and Creed. Along with high class Hostel facility.

Honourary Facilities :

****BAIT-US-SALAAT****

****IMAM BARGAH****



PROFILE

Mohammadi Educational Trust is a Kolkata-India based Isna Ashari Social Organization primarily working in the field of Education actively for last 14 yrs..



MET - *Is an Identity.*

MET - *Is the detection of the vision as an Institution.*

MET - *Defines its process.*

MET - *Gives fair idea of the end product.*

**MET
SAYS IT
ALL.**

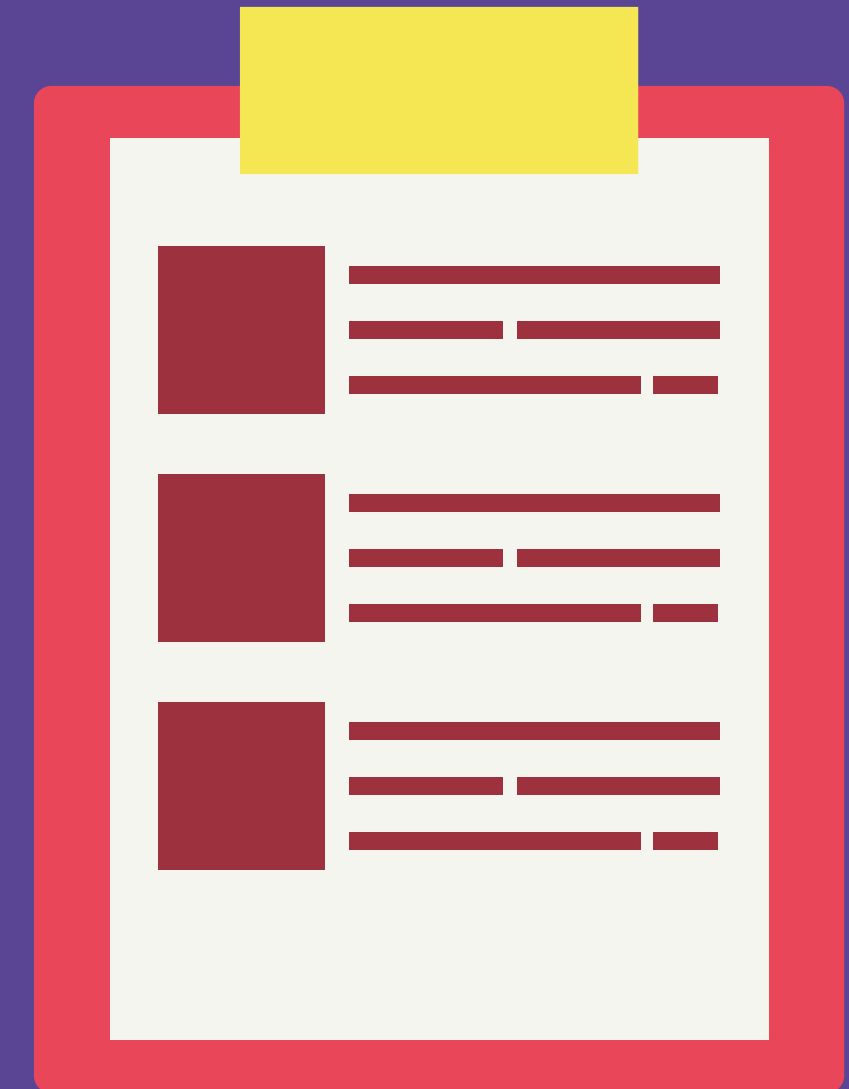

CORE

ADVISORY COMITTEE

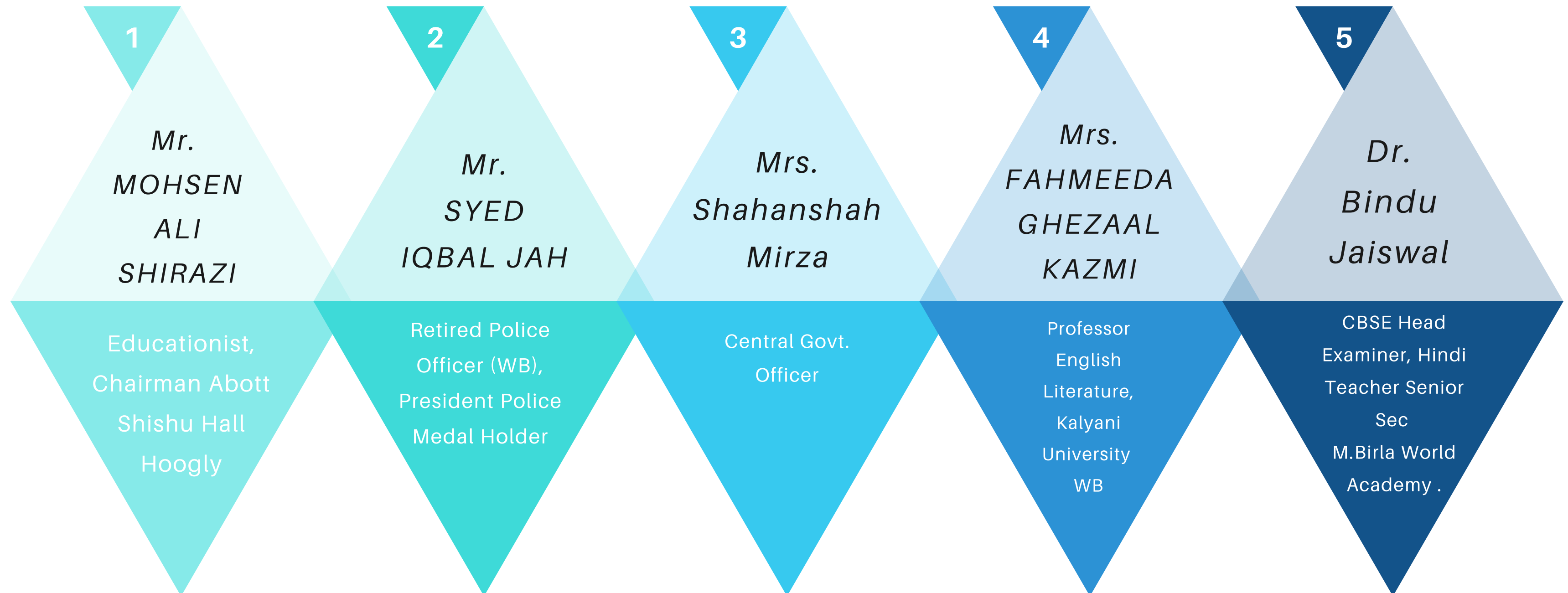

Project Planning Control And Management :
Mr. S.J.A.Rizvi (Anjum), Mr. S. Ashfaque Ahmed & Mr. Talib Hussain

SITE PLAN

**Area of Land
8 Cotthas i.e.,
5760 Sqft**

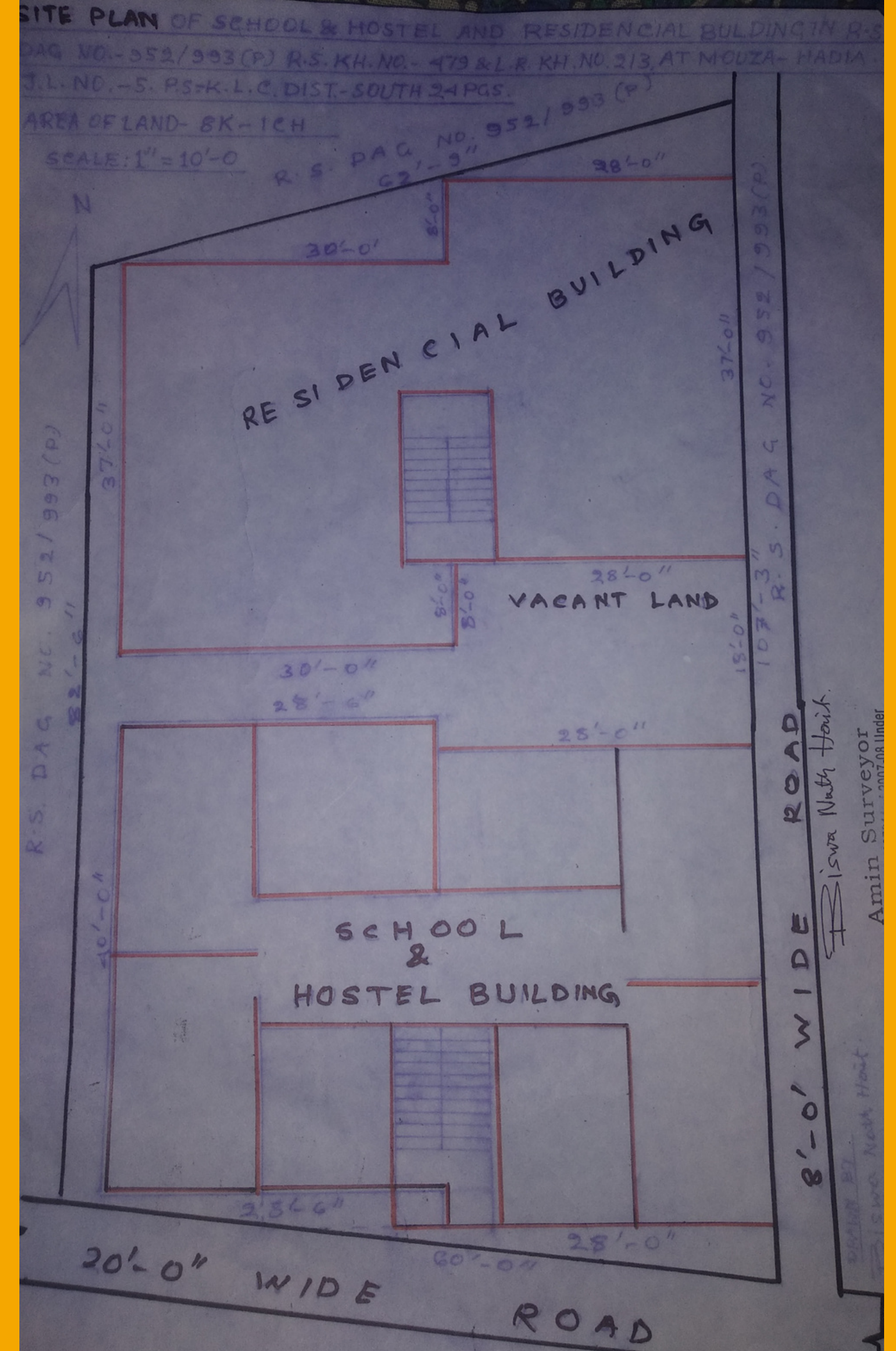

For this Noble Cause.



Kindly come forward and Join Hands and make this Mega Project a Great Success... **INSHA-ALLAH.**

Legacy to be left Forward for upcoming Generations.

ABOUT **MOHAMMADI EDUCATIONAL TRUST**

**REGD. OFF - 24A MARTIN PARA (PURBO
PANCHANNOGRAM) KOLKATA-100.**

CONTACTS

MOBILE - +919903543414

+917044164766

+919748515648

EMAIL - mdedusoc@gmail.com

BANK

**MARTIN PARA MOHAMMADI
EDUCATIONAL SOCIETY.**

**State Bank Of india
C.N.Roy Road Branch (14517)**

**A/C No. 33778726318
IFS COde - SBIN0014517**